

# MAINTENANCE REMINDER SHEET

## X720 with 60" Drive Over Deck

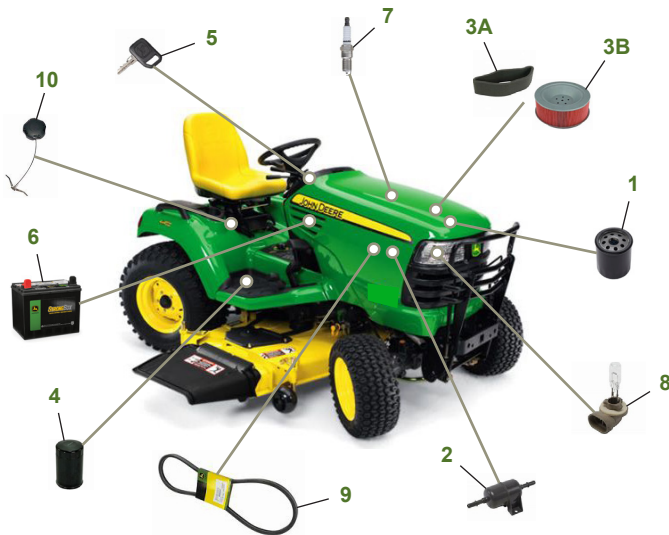

Tractor S/N

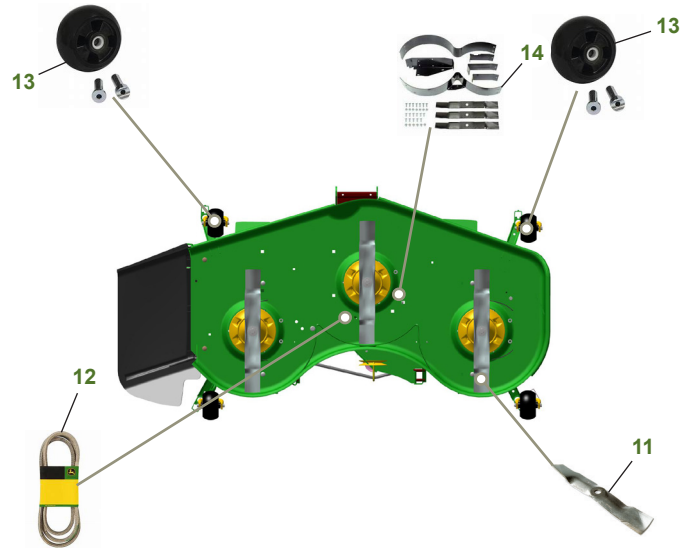

Deck S/N

Key	Part No.	Description	Key	Part No.	Description
1	<a href="#">AM107423</a>	OIL FILTER	9	<a href="#">M147344</a>	FAN BELT
2	<a href="#">AM117584</a>	FUEL FILTER - IN-LINE		<a href="#">M153381</a>	FAN BELT (OPTION)
3A	<a href="#">M148207</a>	AIR FILTER - FOAM	10	<a href="#">AM137724</a>	FUEL CAP (S/N - 060000)
3B	<a href="#">M152049</a>	AIR FILTER - PAPER		<a href="#">AM141406</a>	FUEL CAP(S/N 060001-)
4	<a href="#">UC24341</a>	TRANSMISSION FILTER	11	<a href="#">TCU15881</a>	BLADE - HI LIFT
5	<a href="#">AM131841</a>	KEY - PADDED		<a href="#">M168223</a>	BLADE - MULCHING
6	<a href="#">TY25221B</a>	WET CHARGED BATTERY	12	<a href="#">M120381</a>	BELT
7	<a href="#">M138938</a>	SPARK PLUG	13	<a href="#">AM136720</a>	KIT - GAGE WHEEL
8	<a href="#">R136239</a>	HEADLIGHT BULB	14	<a href="#">TCB10953</a>	MulchControl™ KIT

### Parts Needed in First 200 Hours of Operation

Qty	Part No	Item	Qty or Capacity	Change Interval In Hours
3	<a href="#">AM107423</a>	Oil Filter	1	8/100/200
6	<a href="#">TY26673</a>	1 Gal John Deere Plus 50 II 15W-40 Engine Oil	1.8 L (1.9 qt)	8/100/200
2	<a href="#">UC24341</a>	Transmission Filter	1	50/200
14 12 16	<a href="#">TY22000</a>	1 Gal Low Viscosity Hy-Gard™ Transmission Oil	6.6 L (7 qt) (2WS) 5.6 L (6 qt) (4WS) 6.8 L (7.2 qt) (HFWD)	50/200
1	<a href="#">M148207</a>	Air Filter - Foam	1	200
1	<a href="#">M152049</a>	Air Filter - Paper	1	200
1	<a href="#">AM117584</a>	Fuel Filter	1	200
2	<a href="#">M138938</a>	Spark Plug	2	200
2	<a href="#">TY24416</a>	John Deere Multi-Purpose HD Lithium Complex Grease		As Needed

### Home Maintenance Kit



Unit	Kit Number
X720	<a href="#">LG244</a>

### "As Needed" Parts

Qty	Part No	Item
1	<a href="#">AM130907</a>	Mower Deck Leveling Gauge
1	<a href="#">TY26518</a>	Grease Gun

CLICK PART NUMBER TO BUY