

MAINTENANCE REMINDER SHEET

X700 with 60" Drive Over Deck

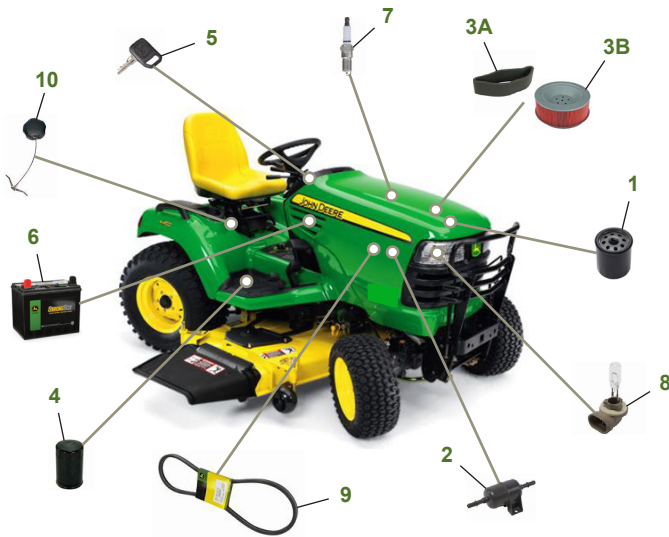

Tractor S/N

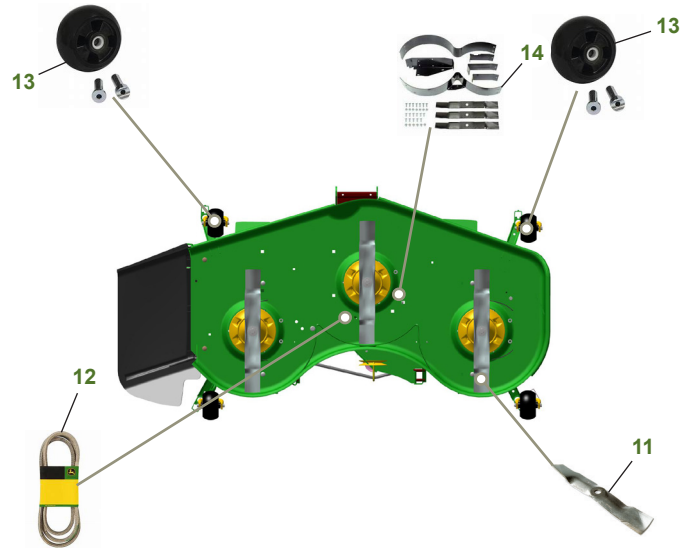

Deck S/N

Key	Part No.	Description	Key	Part No.	Description
1	AM107423	OIL FILTER	8	R136239	HEADLIGHT BULB
2	AM136739	FUEL FILTER - IN-LINE	9	M147344	FAN BELT
3A	M148207	AIR FILTER - FOAM		M153381	FAN BELT (OPTION)
3B	M152049	AIR FILTER - PAPER	10	AM137724	FUEL CAP (S/N - 060000)
4	UC24341	TRANSMISSION FILTER		AM141406	FUEL CAP(S/N 060001-)
5	AM131841	KEY - PADDED	11	TCU15881	BLADE - HI LIFT
6	TY25221B	WET CHARGED BATTERY, FOR CANADA AND USA		M168223	BLADE - MULCHING
	MCYP340PF	WET CHARGED BATTERY, NOT FOR CANADA AND USA	12	M120381	BELT
7	M138938	SPARK PLUG	13	AM136720	KIT - GAGE WHEEL
			14	TCB10953	MulchControl™ KIT

Parts Needed in First 200 Hours of Operation

Qty	Part No	Item	Qty or Capacity	Change Interval In Hours
3	AM107423	Oil Filter	1	8/100/200
6	TY26673	1 Gal John Deere Plus 50 II 15W-40 Engine Oil	1.8 L (1.9 qt)	8/100/200
2	UC24341	Transmission Filter	1	50/200
14 12 16	TY22000	1 Gal Low Viscosity Hy-Gard™ Transmission Oil	6.6 L (7 qt) (2WS) 5.6 L (6 qt) (4WS) 6.8 L (7.2 qt) (HFWD)	50/200
1	M148207	Air Filter - Foam	1	200
1	M152049	Air Filter - Paper	1	200
1	AM136739	Fuel Filter	1	200
2	M138938	Spark Plug	2	200
2	TY24416	John Deere Multi-Purpose HD Lithium Complex Grease		As Needed

Home Maintenance Kit



Unit	Kit Number
X700	LG245

"As Needed" Parts

Qty	Part No	Item
1	AM130907	Mower Deck Leveling Gauge
1	TY26518	Grease Gun

CLICK PART NUMBER TO BUY