

# REPLACEMENT PARTS GUIDE

## W540 Combine (MY 2007 - 2015)

### CAB



**RECIRCULATION AIR FILTER**  
[RE284091](#) - (MY 2012 - 2015)  
[AH115833](#) - (MY 2007 - 2011)

Clean or replace every 50 hours and as required.



**RECIRCULATION AIR FILTER**  
[L214634](#) - (MY 2012 - 2015)  
[H220870](#) - (MY 2007 - 2011)

Clean and Replace as required.

### ENGINE



**MAIN ENGINE GEARCASE FILTER**  
 (ProDrive™ Transmission)  
[AH128449](#)

Change after first 100 hours.

**FUEL PRECLEANER FILTER**

[R502778](#) - (MY 2014 - 2015)  
[AH226195](#) - (MY 2007 - 2011)

**PREMIUM FUEL PRECLEANER FILTER**  
[N378886](#)

Drain every 50 hours or weekly.

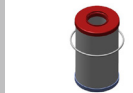

**FINAL TIER 4**

**PRIMARY FUEL FILTER** (MY 2014 - 2015) - [RE520906](#)

**FUEL FILTER KIT** (MY 2014 - 2015)  
[RE541746](#)

**FUEL FILTER**

**PRIMARY FUEL FILTER**  
[RE522878](#) (FINAL TIER 2)

Change as require or when Diagnostic Trouble Code (DTC) is generated.



**VENTILATION SYSTEM** (MY 2014 - 2015) - [DZ105796](#)  
 (W/ DIESEL OXIDATION CATALYST)  
[DZ105100](#)

(W/ DIESEL CATALYST and DIESEL PARTICULATE FILTER)

Change after every 1500 hours.

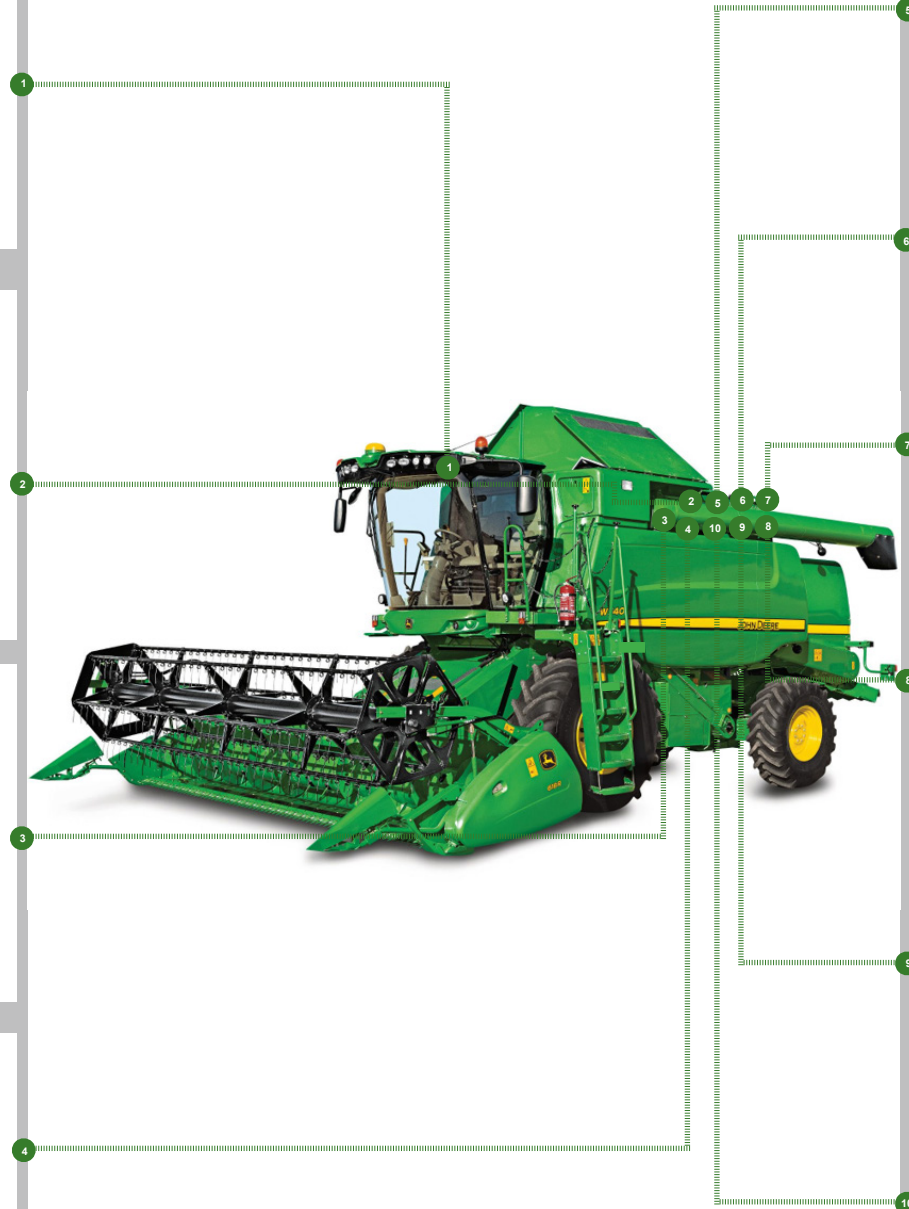

### HYDRAULIC



**MAIN HYDRAULIC OIL FILTER**  
**PRIMARY AIR FILTER**  
[AL203061](#)

Change as require or when Diagnostic Trouble Code (DTC) is generated.

### ENGINE



**OIL FILTER**

[RE539279](#) - (MY 2014 - 2015) (Tier 4)  
[RE504836](#) (Tier 2)

Change after every 250 hours.



**MAIN ENGINE GEARCASE FILTER**  
[CE19990](#)

Change after every 400 hours or every year.



**LONG FILTER**  
**PRIMARY AIR FILTER**  
[AH164062](#)  
**SECONDARY AIR FILTER**  
[AH164063](#)

Change as require or when Diagnostic Trouble Code (DTC) is generated.



**ENGINE**  
**SHORT FILTER**  
**PRIMARY AIR FILTER**  
[AH148880](#)  
**SECONDARY AIR FILTER**  
[RE63932](#)

Change as require or when Diagnostic Trouble Code (DTC) is generated.



**FUEL FILTER**  
[RE529643](#)

Change as require or when Diagnostic Trouble Code (DTC) is generated.



# CAPACITIES

## W540 Combine (MY 2007 - 2015)

### CAPACITIES (Approximate):

**Fuel Tank:**

..... 800 L (210 gal)

**Grain Tank**

..... 8000 L (2113 gal)

**Cooling System with Heater:  
(Cool-Gard II)**

..... 40 L (10.56 gal)

**Engine Crankcase with Filter  
(Plus-50™ II)**

..... 32 L (8.45 gal)

**Transmission (3-Speed Mechanical Shift and Push Button  
Shift) – (GL-5)**

**Transmission**

**(Prodrive™) – (GI-5)  
(MY 2012 - 2015)**

..... 13 L (3.43 gal)

**Final Drive**

**(GI-5)  
(MY 2012 - 2015)**

..... 7 L (1.85 gal)

**(MY2007 - 2011)**

..... 8.5 L (2.24 gal)

**Engine Gearcase with Transfer (3-Speed Mechanical Shift and  
Push Button Shift Machines) – (Hy-Gard™)**

..... 16 L (4.22 gal)

**Engine Gearcase with Transfer**

**(ProDrive™ Machines) –(Hy-Gard™)**

..... 20 L (5.25 gal)

**Hydrostatic / Hydraulic Oil Reservoir**

**(Hy-Gard™)**

..... 34 L (9.51 gal)

**Feeder house reverser gear case**

**(ISO VG 460 Fully Synthetic)**

..... 2 L (0.5 gal)

**Countershaft drive gear case**

**(GL-5)**

..... 1.2 L (0.32 gal)

**Loading Auger Gearcase**

**(GL-5)**

..... 3.8 L (1 gal)

**Diesel Exhaust Fluid (DEF) tank**

**(MY 2014 - 2015)**

..... 32 L (8.45 gal)

[Return to Filter Overview Engine Gearcase with Transfer](#)



# WEAR PARTS OVERVIEW W540 COMBINE

## THRESHING

**MY11-22**

**[AZ58904](#) – RASP BARS**

Paired by weight with deep heat treatment for excellent threshing, good drum balancing and long lifetime.



**MY11-22**

**CHROMED RASP BAR**

**[AH205119](#) LH**

**[AH205120](#) RH**

Chromed rasp bar for toughest conditions.



**MY11-18**

**[AXE53051](#) - UNIVERSAL CONCAVE**



**[AXE53053](#) - SMALL GRAIN CONCAVE**

Exactly welded for easy adjustment and perfect threshing.



**MY16-18**

**[AXE68171](#) – HIGH DIVERSITY UNIVERSAL CONCAVE**



**[AXE68174](#) - HIGH DIVERSITY SMALL GRAIN CONCAVE**

Perfect fit and versatility with the adjustable booster bar.



**MY19-22**

**[AXE61100](#) - HIGH-VERSATILITY CONCAVE**

**[AXE59420](#) - CONCAVE INSERT SMALL GRAIN**

**[AXE59418](#) - CONCAVE INSERT SMALL GRAIN**

**[BXE10910](#) - ROUND BAR CONCAVE INSERT KIT**

High versatility with easy-to-exchange inserts.



## STRAW CHOPPER

### PREMIUM KNIVES

Induction hardened to resist wear and tear at the punched hole and the cutting edge.

**MY11-22**

**[Z103205](#) - PREMIUM CHOPPER SERRATED KNIFE**



**[Z103376](#) - PREMIUM CHOPPER SMOOTH KNIFE**



**[Z105500](#) - PREMIUM HEAVY-DUTY SERRATED KNIFE**



**[Z75874](#) - PREMIUM CHOPPER STATIONARY KNIFE**



### STANDARD KNIVES

Induction hardened to resist wear and tear at the punched hole and the cutting edge.

**MY11-22**

**[Z77601](#) - STANDARD CHOPPER SERRATED KNIFE**



**[Z53454](#) - STANDARD CHOPPER SMOOTH KNIFE**



**[Z42176](#) - STANDARD CHOPPER CORN KNIFE**



**[HXE13024](#) - STANDARD CHOPPER STATIONARY KNIFE SMOOTH**



**[HXE13023](#) - STANDARD CHOPPER STATIONARY KNIFE SERRATED**



# WEAR PARTS OVERVIEW

## W540 COMBINE

### FEEDERHOUSE

#### COMPLETE CONVEYOR CHAIN

Made for smooth running, resisting load spikes and minimal elongation.



MY11-15

[AZ102571](#)



MY16-22

[AXE41943](#)

#### OUTER CHAIN

Made for smooth running, resisting load spikes and minimal elongation.



MY11-15

[AZ63336](#)



[AZ102573](#) (HEAVY DUTY)



MY16-22

[AXE41939](#)

#### INNER CHAIN

Made for smooth running, resisting load spikes and minimal elongation.



MY11-15

[AZ63337](#)



[AZ102574](#) (HEAVY DUTY)



MY16-22

[AXE41940](#)

#### SLAT

Modern machining prevents burrs and edges, and the design is optimized for efficient and gentle crop handling.



[Z100722](#)



### GRAIN HANDLING

#### [AZ101808](#) - CLEAN GRAIN ELEVATOR CHAIN

Made for smooth running, resisting load spikes and minimal elongation.



### STRAW WALKER

#### [AZ45586](#) - BEARING

Original John Deere bearings don't warp, open, crack or break, nor will they seize on the shaft.

