

FILTER OVERVIEW WITH SERVICE INTERVALS AND CAPACITIES

(-765000) S-Series Combines S550, S560

ENGINE

ENGINE FUEL FILTERS



[RE522878](#) (S550)



FUEL WATER SEPARATOR PRE-FILTER
[RE529643](#) STANDARD (S550)



FUEL WATER SEPARATOR PRE-FILTER
[R502778](#) STANDARD (S560)



FUEL WATER SEPARATOR PRE-FILTER
[N378886](#) PREMIUM (S550 - S560)



[RE525523](#) (DUAL S560)
Replace fuel filters every 400 hours.

ENGINE, AIR, SECONDARY



[AH212295](#) (S560)

Change Secondary filter only with Primary filter. Change or replace after 400 hours as required with Primary Air Filter.

ENGINE OIL FILTER



[RE504836](#) (S550)
[RE509672](#) (S560)

Minimum hours before first engine oil change is 100 hours. Extended engine oil change every 500 hours or annually, whichever come first. The extended 500 hour interval is only allowed if using Plus-50™ II oil with a John Deere filter and diesel fuel with sulfur content less than 15mg/kg (15ppm). If all conditions are not met, change oil and filter at 250 hours of operation.



ENGINE, AIR, PRIMARY

[AH222225](#) (S550, S560)

Clean or Replace every 400 hours and as required.



ProDrive™ FILTER

[AH128449](#) (S560)

Replace after first 100 hours, then every 400 hours.

HYDRAULIC



HYDRAULIC/MAIN ENGINE GEAR CASE FILTER

[AH128449](#) (S550)
Replace every 400 hours.



HYDROSTATIC CHARGE FILTER (CLOSED CENTER)

[AH128449](#) (S550)
Replace every 400 hours.



HYDROSTATIC DRIVE PUMP FILTER (ProDrive™ TRANSMISSION)

[AN207368](#) (S550)



HYDRAULIC RETURN FILTER (RESERVOIR)

[AXE12964](#) (S550)
Replace every 1000 hours

CAB



FRESH AIR FILTER

[RE284091](#) (S550)



[AH115833](#) STANDARD, (S560)



[AH168783](#) HEAVY DUTY, (S560)

Clean or replace every 50 hours and as required.



MAIN ENGINE GEARCASE FILTER

[CE19990](#)

Replace within first 100 hours and every 400 hours.

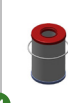

FUEL FILTER PRIMARY FUEL FILTER

[RE520906](#)



PRIMARY AND SECONDARY FUEL FILTER

[RE525523](#)

Change as require or when Diagnostic Trouble Code (DTC) is generated.



RECIRCULATION AIR FILTER

[L214634](#) (S560)

[H220870](#) (S560)

Clean or replace every 200 hours and as required.

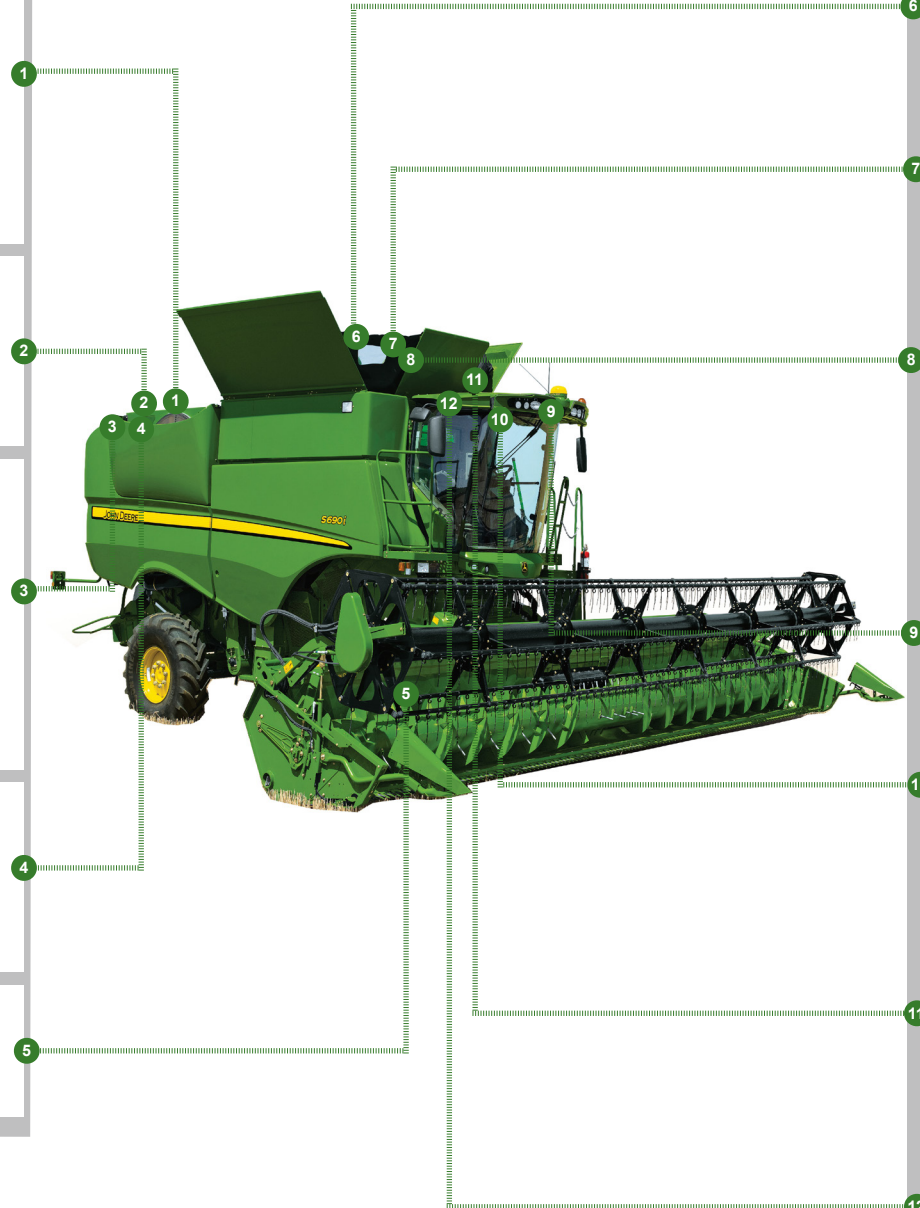

JOHN DEERE
Genuine Parts and Service

CAPACITIES

(-765000) S-Series Combines S550, S560

CAPACITIES (Approximate):

Fuel Tank:

S550 757 L (200 gal)

Cooling System with Heater:

Cool-Gard™ II

S550 43 L (11.4 gal)

Engine Crankcase with Filter:

Plus-50™ II

S550 32 L (8.5 gal)

Transmission:

GL-5

S550 9.6 L (2.53 gal)

Final Drives:

GL-5

All Models 8 L (2.11 gal)

Countershaft Drive Gearcase:

GL-5

All Models 1.2 L (0.31 gal)

Heavy-Duty Feeder House Reverser Gearcase w/out Cooler:

ISO VG 460 Fully Synthetic

S550 2.3 L (0.60 gal)

Heavy-Duty Feeder House Reverser Gearcase with Cooler:

ISO VG 460 Fully Synthetic

S550, S560 3.5 L (0.92 gal)

Loading Auger Gearcase:

GL-5

All Models 3.8 L (1 gal)

Two Speed Separator Drive Gearcase:

GL-5

S550 2.4 L (0.63 gal)

Engine Gearcase with Transfer:

Hy-Gard™

S550, S560 21.3 L (5.6 gal)

Premium Overshot Beater Gearcase (if equipped):

GL-5

All Models 0.2 L (0.05 gal)

Hydraulic/Hydrostatic Reservoir:

Hy-Gard™

S550 35 L (9.2 gal)

[Return to Filter Overview](#)

