

FILTER OVERVIEW WITH SERVICE INTERVALS AND CAPACITIES

CP770 Cotton Picker

ENGINE
SECONDARY FUEL FILTER
DZ124786
 Replace every 400 hours or annually, whichever occurs first.



CAB
RECIRCULATION AIR FILTER
AXE70605
 Clean or replace every 250 hours or as required. If operating in dusty conditions clean daily.



CAB
FRESH AIR FILTER
RE284091
 Clean or replace every 50 hours or as required. If operating in dusty conditions clean daily.

FUEL TANK
TANK BREATHER – H216169
 Replace every 2000 hours.



ENGINE
PRIMARY FUEL FILTER
DZ124761
 Replace every 400 hours or annually, whichever occurs first.



ENGINE
OIL FILTER – RE572785
 Minimum hours before first engine oil change is 100 hours. Extended engine oil change every 375 hours or annually, whichever come first. The extended 375 hour interval is only allowed if using Plus-50™ II oil with a John Deere filter and diesel fuel with sulfur content less than 15mg/kg (15ppm). If all conditions are not met, change oil and filter at 250 hours of operation.



(Click here for [capacity](#))

ENGINE
SECONDARY AIR FILTER
HXE11091
 Replace every 400 hours or annually, whichever occurs first.



ENGINE
DIESEL EXHAUST FLUID DOSING FILTER – DZ114640
 Replace after first 1500 hours or 3 years, whichever occurs first.



(Click here for [capacity](#))

ENGINE
PRIMARY AIR FILTER
HXE11090
 Replace every 400 hours or as required.



ENGINE
DIESEL EXHAUST FLUID IN-LINE FILTER – DZ110513
 Replace after first 1500 hours or 3 years, whichever occurs first.



(Click here for [capacity](#))

HYDRAULICS
PUMP FILTER – AKK43338
 Replace every 1000 hours.



ENGINE
FUEL PRECLEANER FILTER
R502778
 Replace every 400 hours or annually, whichever occurs first.



HYDRAULICS
AUXILIARY GEAR CASE OIL FILTER
AKK28711
 Replace every 1000 hours.
 (Click here for [capacity](#))



UNIT GREASE SYSTEM LUBRICATION SYSTEM FILER
AN192848 (2)
 Replace every 250 hours.

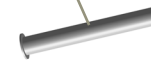

HYDRAULICS
PROPEL PUMP CHARGE FILTER – RE273801
 Replace every 1000 hours.
 (Click here for [capacity](#))



CHASSIS RETURN OIL FILTER
AKK33523
 Replace every 1000 hours.
 (Click here for [capacity](#))



CAPACITIES

CP770 Cotton Picker

CAPACITIES (Approximate):

Fuel Tank:

..... 1250 L (330 gal)

Diesel Exhaust Fuel Tank (Final Tier 4/Stage IV only): John Deere Diesel Exhaust Fluid™

..... 104.4 L (27.5 gal)

Moisture Solution Tank:

John Deere Spindle Cleaner™

..... 1363 L (360 gal)

Cooling System:

Cool-Gard™ II

Final Tier 4 / Stage IV 68.1 L (18 gal)

Engine Crankcase (Includes Filter):

Plus-50™ II

Final Tier 4/Stage IV 56.7 L (15 gal)

Hydraulic Oil Reservoir:

Hy-Gard™

..... 113.5 L (30 gal)

Hydraulic/Hydrostatic System:

Hy-Gard™

..... 216 L (57 gal)

Final Drive: (2 used)

GL-5

Standard Capacity 7.8 L (2 gal)

High Capacity 23 L (6.1 gal)

Lubrication System Grease Tank:

John Deere Spindle Lubricant™

..... 257 L (68 gal)

Row Unit Gearcase: (6 used)

Hy-Gard™

..... 0.66 L (0.17 gal)

Rear Axle Main Body Housing:

GL-5

..... 9.9 L (2.6 gal)

Rear Axle Auxiliary Gearbox:

GL-5

..... 1.3 L (0.34 gal)

Rear Axle Planetary (2 Used):

GL-5

..... 3.8 L (1 gal)

[Return to Filter Overview](#)

