

FILTER OVERVIEW WITH SERVICE INTERVALS AND CAPACITIES

9RT Interim Tier 4 (IT4) Series Track Tractors - 9460RT, 9510RT, 9560RT

CAB

**RECIRCULATION FILTER - [RE291412](#)
[RE333569](#) (Carbon)**

Replace after every 1000 hours or annually, whichever occurs first.

(Interval may vary according to operating conditions.)

DIESEL PARTICULATE FILTER (DPF) (IT4 ONLY) - [RE541836](#)

Service as indicated by machine. See your John Deere™ dealer or qualified service provider.

ENGINE

SECONDARY AIR FILTER - [RE230985](#)

Replace annually.
(Interval may vary according to operating conditions.)

ENGINE

PRIMARY AIR FILTER - [RE312946](#)

Replace annually.
(Interval may vary according to operating conditions.)

ENGINE

OIL FILTER - [RE572785](#)

Initial oil and filter change at 100 hours, then after every 500 hours or annually, whichever occurs first.

The extended 500 hour interval is only allowed if using PLUS-50™ II oil with a John Deere filter and diesel fuel with sulfur content less than 15mg/kg (15ppm).

If all the conditions are not met, change oil and filter at 250 hours of operation.

(Click here for [capacity](#))

ENGINE

(IT4 ONLY)

**PRIMARY FUEL FILTER - [RE539465](#)
SECONDARY FUEL FILTER - [RE533910](#)**

TIER 2 AUSTRALIA 6135RW201 (9460RT, 9510RT, 9560RT)

**PRIMARY FUEL FILTER - [RE532952](#)
SECONDARY FUEL FILTER - [RE533910](#)**

Replace after every 500 hours or as indicated, whichever occurs first.

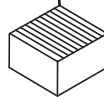
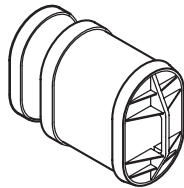
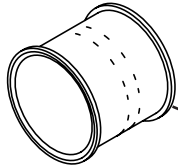
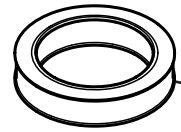

ENGINE

FUEL WATER SEPARATOR FILTER (If equipped) - [N378886](#)

Clean after every 500 hours, then after every fifth back flushing of water separator assembly or as necessary.

HYDRAULICS

HYDRAULIC OIL FILTER - [RE577612](#) X2

Replace after every 1500 hours.
(Interval may vary according to operating conditions.)

(Click here for [capacity](#))

CAB

**FRESH AIR FILTER - [RE284091](#)
[RE333567](#) (Carbon)**

Replace after every 1000 hours or annually, whichever occurs first.

(Interval may vary according to operating conditions.)

ENGINE

FUEL TANK VENT FILTER - [H216169](#)

Clean after every 1000 hours and replace after every 1500 hours.

(Interval may vary according to operating conditions.)

HYDRAULIC

REAR AXLE FILTER - [RE577612](#)

Replace after every 1500 hours.
(Interval may vary according to operating conditions.)

HYDRAULICS

STEERING FILTER - [RE577250](#)

Replace after every 1500 hours.
(Interval may vary according to operating conditions.)

(Click here for [capacity](#))

TRANSMISSION

OIL FILTER - [RE577612](#)

Replace after every 1500 hours.
(Interval may vary according to operating conditions.)

(Click here for [capacity](#))



JOHN DEERE

Genuine Parts and Service

CAPACITIES

9RT Interim Tier 4 (IT4) Series Track Tractors - 9460RT, 9510RT, 9560RT

CAPACITIES (Approximate):

Fuel Tank

..... 1287 L (340 gal)

Cooling System:

Cool-Gard™ II

IT4/ Stage III B..... 55.1 L (14.6 gal)

Tier2/ Stage II..... 42 L (11.1 gal)

Crankcase with Filter:

Plus-50™ II

IT4/ Stage III B..... 48 L (12.7 gal)

Tier2/ Stage II..... 60 L (15.8 gal)

18-Speed Powershift Transmission/Hydraulic/Axle System:

Hy-Gard™

Hydraulic Reservoir Volume Reference Marks

Full - Hot..... 131.4 L (34.7 gal)

Full - Cold..... 100.2 L (26.5 gal)

Min Cold..... 88.9 L (23.5 gal)

Do Not Start..... 66.8 L (17.5 gal)

PowerShift™ Transmisson/Hydraulic Reservoir/Rear Axle:

Hy-Gard™

Total System Volume (Standard Flow)..... 299.5 L (79.1 gal)

Total System Volume (High Flow)..... 310.9 L (82.1 gal)

Fill Volume Reservoir (Standard Flow)..... 100.7 L (26.6 gal)

Fill Volume Reservoir (High Flow)..... 112.0 L (29.6 gal)

Fill Volume Powershift Transmisson..... 37.9 L (10 gal)

Fill Volume Rear Axle..... 160.9 L (42.5 gal)

Additional Volume for PTO..... 3.8 L (1.0 gal)

Additional Volume for Hitch..... 3.8 L (1.0 gal)

Additional Volume Prefill 75cc Hydraulic Pump..... 3.8 L (1.0 gal)

Additional Volume Prefill 45cc High Flow

Hydraulic Pump..... 3.8 L (1.0 gal)

Additional Volume Prefill Tracks Steering Pump..... 3.8 L (1.0 gal)

[Return to Filter Overview](#)



JOHN DEERE

Genuine Parts and Service