

FILTER OVERVIEW WITH SERVICE INTERVALS AND CAPACITIES

9050 Walker Series Combines

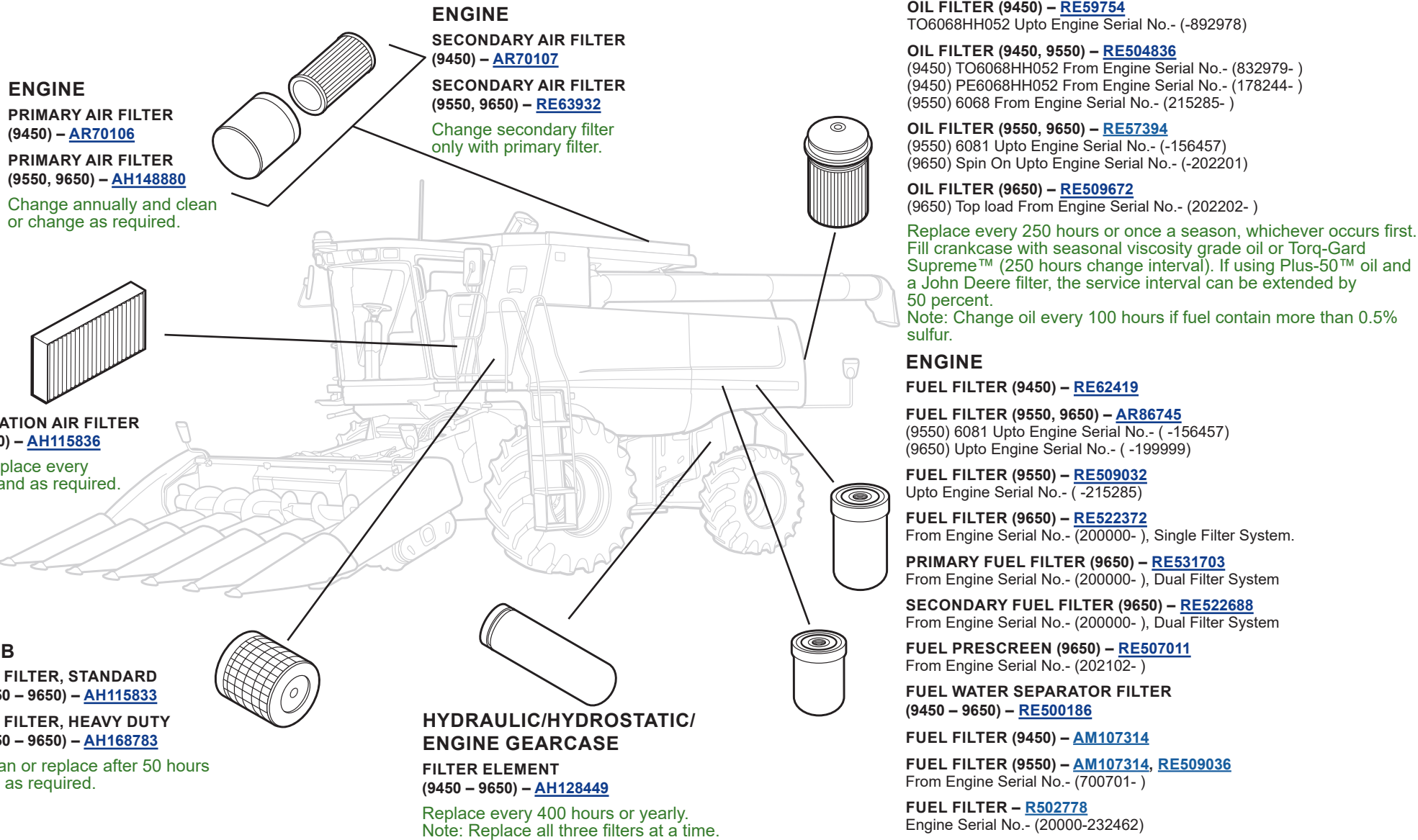

ENGINE
PRIMARY AIR FILTER
 (9450) – [AR70106](#)
PRIMARY AIR FILTER
 (9550, 9650) – [AH148880](#)

Change annually and clean or change as required.

ENGINE
SECONDARY AIR FILTER
 (9450) – [AR70107](#)
SECONDARY AIR FILTER
 (9550, 9650) – [RE63932](#)

Change secondary filter only with primary filter.

CAB
RECIRCULATION AIR FILTER
 (9450 – 9650) – [AH115836](#)

Clean or replace every 200 hours and as required.

CAB
AIR FILTER, STANDARD
 (9450 – 9650) – [AH115833](#)
AIR FILTER, HEAVY DUTY
 (9450 – 9650) – [AH168783](#)

Clean or replace after 50 hours and as required.

**HYDRAULIC/HYDROSTATIC/
 ENGINE GEARCASE
 FILTER ELEMENT**
 (9450 – 9650) – [AH128449](#)

Replace every 400 hours or yearly.
 Note: Replace all three filters at a time.

ENGINE

OIL FILTER (9450) – [RE59754](#)
 TO6068HH052 Upto Engine Serial No.- (-892978)

OIL FILTER (9450, 9550) – [RE504836](#)
 (9450) TO6068HH052 From Engine Serial No.- (832979-)
 (9450) PE6068HH052 From Engine Serial No.- (178244-)
 (9550) 6068 From Engine Serial No.- (215285-)

OIL FILTER (9550, 9650) – [RE57394](#)
 (9550) 6081 Upto Engine Serial No.- (-156457)
 (9650) Spin On Upto Engine Serial No.- (-202201)

OIL FILTER (9650) – [RE509672](#)
 (9650) Top load From Engine Serial No.- (202202-)

Replace every 250 hours or once a season, whichever occurs first. Fill crankcase with seasonal viscosity grade oil or Torq-Gard Supreme™ (250 hours change interval). If using Plus-50™ oil and a John Deere filter, the service interval can be extended by 50 percent.
 Note: Change oil every 100 hours if fuel contain more than 0.5% sulfur.

ENGINE

FUEL FILTER (9450) – [RE62419](#)

FUEL FILTER (9550, 9650) – [AR86745](#)
 (9550) 6081 Upto Engine Serial No.- (-156457)
 (9650) Upto Engine Serial No.- (-199999)

FUEL FILTER (9550) – [RE509032](#)
 Upto Engine Serial No.- (-215285)

FUEL FILTER (9650) – [RE522372](#)
 From Engine Serial No.- (200000-), Single Filter System.

PRIMARY FUEL FILTER (9650) – [RE531703](#)
 From Engine Serial No.- (200000-), Dual Filter System

SECONDARY FUEL FILTER (9650) – [RE522688](#)
 From Engine Serial No.- (200000-), Dual Filter System

FUEL PRESCREEN (9650) – [RE507011](#)
 From Engine Serial No.- (202102-)

FUEL WATER SEPARATOR FILTER
 (9450 – 9650) – [RE500186](#)

FUEL FILTER (9450) – [AM107314](#)

FUEL FILTER (9550) – [AM107314](#), [RE509036](#)
 From Engine Serial No.- (700701-)

FUEL FILTER – [R502778](#)
 Engine Serial No.- (20000-232462)

FUEL FILTER (9650) – [R502778](#)
 From Engine Serial No.- (695407-) Also for 695394, 695395, 695401, 695402, 695405

Replace every 500 hours and as required.



CAPACITIES

9050 Walker Series Combines

CAPACITIES (Approximate):

Fuel Tank:

..... 565 L (150 gal)

Cooling System including Heater:

Cool-Gard™

9450..... 36 L (9.5 gal)

9650..... 40 L (10.6 gal)

Engine Crankcase including Filter:

Plus-50™

9450..... 18.9 L (5 gal)

9550..... 32 L (8.5 gal)

9650..... 28.5 L (7.5 gal)

Transmission:

GL-5

..... 9.6 L (2.5 gal)

Final Drives (Each):

GL-5

9450-9550 8.5 L (2.2 gal)

9650 Regular Duty Single Reduction 8.5 L (2.2 gal)

9650 Heavy Duty Single Reduction..... 3.8 L (1 gal)

Feeder House Reverser Gearcase without Cooler:

GL-5

..... 2.3 L (0.6 gal)

Feeder House Reverser Hi-Cap with Cooler:

GL-5

9550-9650 3.5 L (0.9 gal)

Primary Countershaft Drive Gearcase:

GL-5

..... 1.2 L (0.3 gal)

Beater/Straw Walker Drive Gearcase:

John Deere Corn Head Grease

..... 400 cc (14 oz)

Dual-Range Cylinder Drive Gearcase:

GL-5

..... 1.9 L (0.5 gal)

Engine Gearcase:

Low Viscosity Hy-Gard™

..... 16 L (4.2 gal)

Loading Auger Gearcase:

GL-5

9450..... 3.8 L (1 gal)

Hydraulic/Hydrostatic Reservoir:

Low Viscosity Hy-Gard™

9450..... 34 L (9 gal)

[Return to Filter Overview](#)

