

# FILTER OVERVIEW WITH SERVICE INTERVALS AND CAPACITIES

## 7460 Cotton Stripper

### CAB

**FRESH AIR FILTER**  
(STANDARD) – [AH115833](#)  
(HEAVY DUTY) – [AH168783](#)

Clean every 50 hours. Replace as required.

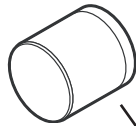

### CAB

**RECIRCULATION AIR FILTER**  
– [AH115836](#)

Clean every 10 hours.  
Replace as required.

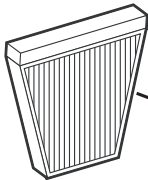

### HYDRAULICS

**HYDRAULIC RESERVOIR**  
(S/N -030000) – [AE43494](#) (QTY 1)  
(S/N -030000) – [AN220456](#) (QTY 2)  
(S/N 030001-) – [AE43494](#) (QTY 1)  
(S/N 030001-) – [AN220314](#) (QTY 1)

**HYDRAULIC RETURN**  
– [T175002](#)

Replace after 400 hours.

(Click here for [capacity](#))

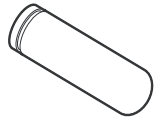

### ENGINE

**PRIMARY FUEL FILTER**  
(6068TN) – [RE508633](#)  
(6068HN) – [RE541922](#)

Replace every 250 hours and as required.  
If John Deere Plus-50™ oil is used, along with a John Deere oil filter, the oil change interval may be extended by 50 percent, up to 375 hours.



### ENGINE

**FINAL FUEL FILTER**  
(6068TN) – [RE62419](#)  
(6068HN) – [RE522878](#)

Replace every 250 hours and as required.  
If John Deere Plus-50™ oil is used, along with a John Deere oil filter, the oil change interval may be extended by 50 percent, up to 375 hours.



### ENGINE

**PRIMARY AIR FILTER**  
(S/N -030000) – [RE65880](#)  
(S/N 030001-) – [AN221846](#)

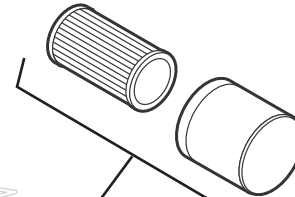

### SECONDARY AIR FILTER

(S/N -030000) – [RE34967](#)  
(S/N 030001-) – [AN221847](#)

Replace every year  
and as required.



### ENGINE

**OIL FILTER**  
(6068TN) – [RE59754](#)  
(6068HN) – [RE504836](#)

Replace after first 100 hours, then 200 hours or once each season, whichever comes first. If John Deere Plus-50™ oil is used, along with a John Deere oil filter, the oil change interval may be extended by 50 percent, up to 500 hours.

(Click here for [capacity](#))

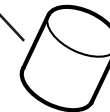

**WATER FUEL SEPARATOR FILTER**  
(6068HN) – [R100369](#)



**JOHN DEERE**

Genuine Parts and Service

# CAPACITIES

## 7460 Cotton Stripper

### CAPACITIES (Approximate):

#### Cotton Basket:

.....22.88 m<sup>3</sup> (808 cu. ft.)

#### Fuel Tank:

.....454 L (120 gal)

#### Cooling System:

.....33.1 L (8.75 gal)

#### Engine Crankcase including Filter:

.....27.44 L (7.3 gal)

#### Hydraulic and Hydrostatic Reservoir:

.....81.8 L (21.6 gal)

#### Hydraulic and Hydrostatic System:

.....117.3 L (31 gal)

#### Transmission:

.....13.6 L (3.6 gal)

#### Final Drive (Each):

.....1.9 L (0.5 gal)

#### Cleaner Gear Case:

.....1 L (0.2 gal)

[Return to Filter Overview](#)