

FILTER OVERVIEW WITH SERVICE INTERVALS AND CAPACITIES

5003 Series Utility Tractors - 5103, 5203, 5303, 5403

TRANSMISSION

FILTER ELEMENT – [RE45864](#)

Replace after 100 and 250 hours, and then every 250 hours.

(Click here for [capacity](#))

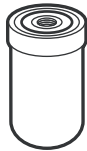

ENGINE

OIL FILTER (5103–5303)– [T19044](#)

5103 (ESN -140838)
5203 (ESN -140336)
5303 (ESN -103382)



ENGINE

OIL FILTER (5103-5403) – [RE519626](#)

5103 (ESN 106597-)
5203 (ESN 106478-)
5303 (ESN 103383-)
5403

Replace after 100 hours and then after every 250 hours or one year.

(Click here for [capacity](#))



ENGINE

FUEL FILTER – [RE60021](#)

Replace every 500 hours or every year and as required.

ENGINE

PRIMARY AIR FILTER

5103 (TSN -009122), 5203 (TSN -001465) – [RE68048](#)
5103 (TSN 009123-), 5203 (TSN 001466-), 5303, 5403 – [AT171853](#)

SECONDARY AIR FILTER

5103 (TSN -009122), 5203 (TSN -001465) – [RE68049](#)
5103 (TSN 009123-), 5203 (TSN 001466-), 5303, 5403 – [AT171854](#)

Clean every 250 hours and replace every year.

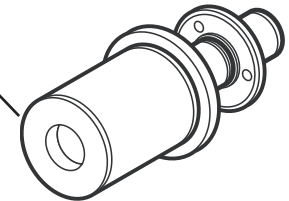

JOHN DEERE

Genuine Parts and Service

CAPACITIES

5003 Series Utility Tractors - 5103, 5203, 5303, 5403

CAPACITIES (Approximate):

Fuel Tank:

Open Station..... 68 L (18 gal)

Cooling System:

Cool-Gard™ II Premix

..... 9.5 L (2.51 gal)

Engine including Filter Change:

Plus-50™

..... 8.5 L (2.25 gal)

Transmission and Hydraulic System:

Hy-Gard™

2WD..... 38 L (10 gal)

4WD..... 39 L (11 gal)

Mechanical Front Wheel Drive (MFWD) Axle:

Hy-Gard™

Wheel Hub (Each) 0.8 L (0.21 gal)

Axle Housing 5 L (1.32 gal)

[Return to Filter Overview](#)

