

FILTER OVERVIEW WITH SERVICE INTERVALS AND CAPACITIES

4010 Series Compact Utility Tractors - 4010, 4110, 4115, 4210, 4310, 4410, 4510, 4610, 4710

ENGINE

OIL FILTER

(4010, 4110) – [M806418](#)

(4115 – 4710) – [M806419](#)

Replace after initial 50 hours, then every 200 hours.

(Click here for [capacity](#))

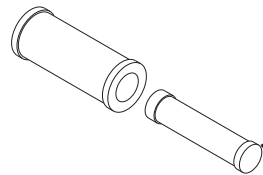

ENGINE

PRIMARY AIR FILTER

(4010, 4110, 4115) – [M113621](#)

(4210 – 4710) – [M131802](#)

SECONDARY AIR FILTER

(4010, 4110, 4115) – [M123378](#)

(4210 – 4710) – [M131803](#)

Replace as required.

FILTER PAK

(4110) – [LVA21197](#)

M806418, CH15553, LVU800097, M113621, LVU18835

(4210, 4310, 4410) – [LVA21194](#)

M806419, M801101, LVA11522, LVA10419, M131802, LVU17801, LVU17802

Each kit contains above filters and offering a complete solution for your maintenance needs to keep your tractor running at peak performance.

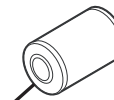

TRANSMISSION / HYDRAULIC OIL FILTER

(4010) – [LVA802833](#)

(4110, 4115) – [LVU800097](#)

(4210 – 4710) – [LVA10419](#) and [LVA11522](#)

For Hydro Models, replace after initial 50 hours. Replace every 200 hours.

(Click here for [capacity](#))

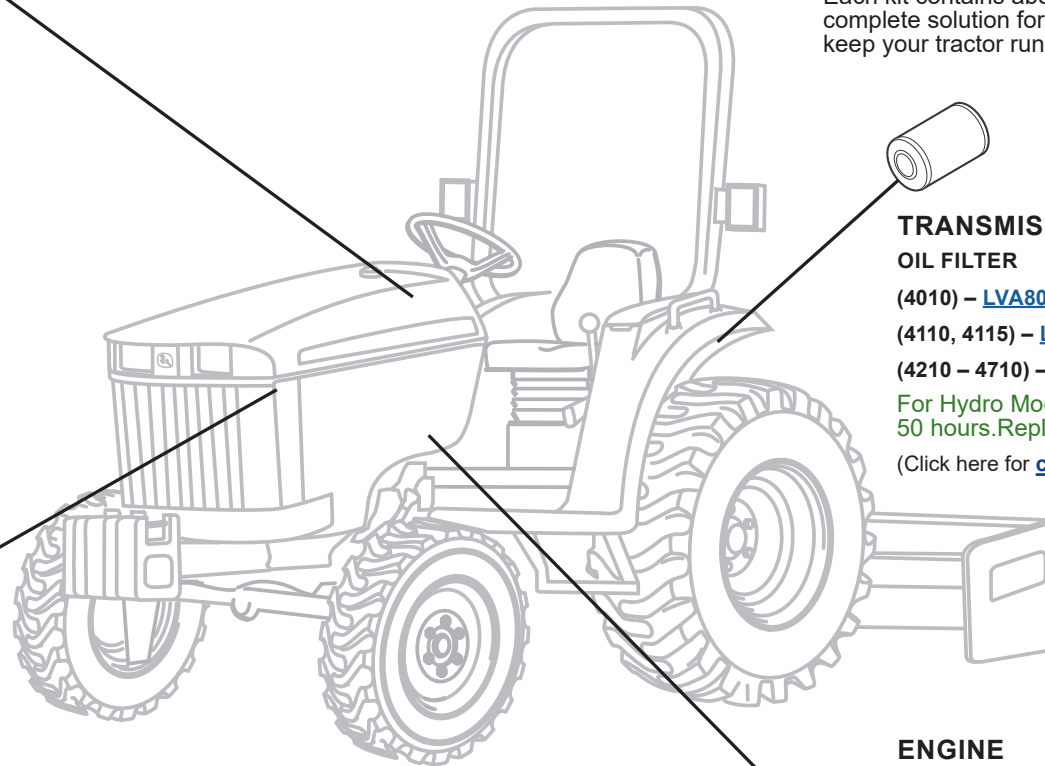

ENGINE

FUEL FILTER

(4010, 4110, 4115) – [CH15553](#)

(4210, 4310, 4410) – [M801101](#)

(4510, 4610, 4710) – [T111383](#)

Replace every 500 hours.



JOHN DEERE

Genuine Parts and Service

CAPACITIES

4010 Series Compact Utility Tractors - 4010, 4110, 4115, 4210, 4310, 4410, 4510, 4610, 4710

CAPACITIES (Approximate):

Fuel Tank:

4010.....	13 L (3.4 gal)
4110.....	22 L (5.8 gal)
4115.....	27 L (7.1 gal)
4210, 4310, 4410.....	37.9 L (10 gal)
4510, 4610, 4710.....	47.5 L (12.6 gal)

Cooling System:

Cool-Gard™ II

4010, 4110, 4115.....	2.4 L (0.63 gal)
4210.....	5.3 L (1.4 gal)
4310, 4410.....	5.7 L (1.51 gal)
4510.....	6.1 L (1.61 gal)
4610, 4710.....	6.4 L (1.69 gal)

Crankcase with Filter:

Plus-50™ II

4010, 4115.....	2 L (0.53 gal)
4110.....	2.2 L (0.58 gal)
4210.....	3.8 L (1 gal)
4310, 4410.....	4.3 L (1.14 gal)
4510, 4610, 4710.....	4.8 L (1.27 gal)

Transmission and Hydraulic System:

Low Viscosity Hy-Gard™

4010.....	10 L (2.6 gal)
4110 (Gear Models).....	13.5 L (3.6 gal)
4110 (Hydrostatic Models).....	13.3 L (3.5 gal)
4115.....	14.6 L (3.8 gal)
4210, 4310, 4410 (Gear Models).....	24 L (6.3 gal)
4210, 4310, 4410 (Hydrostatic Models).....	26 L (6.9 gal)
4510, 4610, 4710 (Gear Models).....	36.9 L (9.7 gal)
4510, 4610, 4710 (Hydrostatic Models).....	35 L (9.2 gal)

Front Axle:

GL-5 Lubricant 80W-90

4010, 4110, 4115.....	3.4 L (0.90 gal)
-----------------------	------------------

Low Viscosity Hy-Gard™

4210, 4310, 4410.....	4.5 L (1.19 gal)
4510, 4610, 4710.....	5 L (1.32 gal)

[Return to Filter Overview](#)

